



# WATERSOUND ORIGINS<sup>®</sup> TOWN CENTER

*PUBLIX CENTER: RETAIL SPACE AVAILABLE*

## AVAILABLE RETAIL SPACE US HIGHWAY 98, WATERSOUND, FLORIDA

### PROJECT PIPELINE SUMMARY

- Publix Supermarket + Liquor Store plus 10,675 square feet of Inline Retail Space (2021)
- 217 luxury apartments (2020)
- 150-unit senior living facility (2021)
- 64 Townhomes ( 2021)
- Magnet Innovation Center (STEAM High School) (2020)
- Sacred Heart Clinic (2020)

### AVAILABLE SPACES

#### IN-LINE RETAIL

- 8 units available
- 1,200 SF To 2,275 SF
- NNN
- Units can be combined
- Use restrictions may apply
- Warm vanilla shell
- AADT: 23,500



## CONTACT

**Jordan Rosenau** | Sales & Leasing Director  
850.231.6430 / Jordan.Rosenau@joe.com

**Daphne Corr** | Sales & Leasing Coordinator  
850.231.6583 / Daphne.Corr@joe.com

**Samantha Walton** | Sales & Leasing Coordinator  
850.231.6531 / Samantha.Walton@joe.com

• **JOE.COM** / The St. Joe Company  
• 133 S. WaterSound Parkway, WaterSound, FL 32461



# WATERSOUND TOWN CENTER

PUBLIX CENTER: RETAIL SPACE AVAILABLE

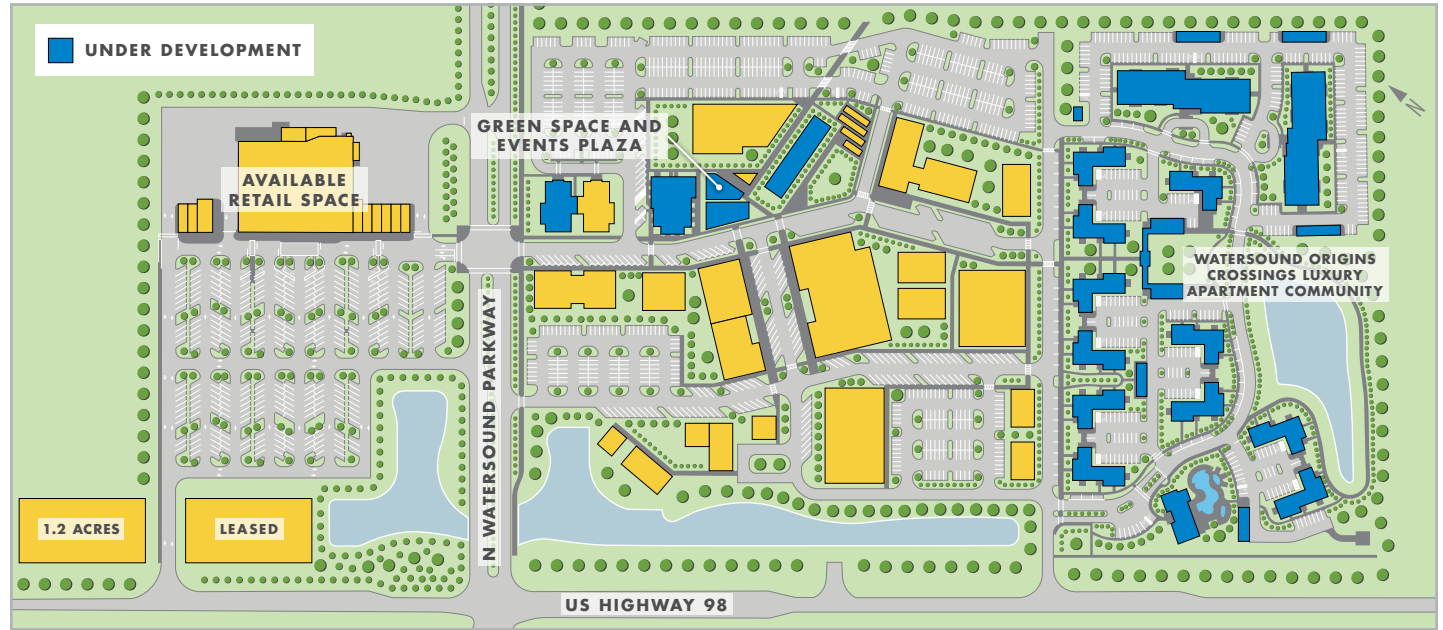
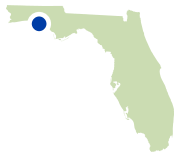

## CONTACT

**Jordan Rosenau** | Sales & Leasing Director  
850.231.6430 / Jordan.Rosenau@joe.com

**Daphne Corr** | Sales & Leasing Coordinator  
850.231.6583 / Daphne.Corr@joe.com

**Samantha Walton** | Sales & Leasing Coordinator  
850.231.6531 / Samantha.Walton@joe.com

### JOE.COM

The St. Joe Company

133 S. WaterSound Parkway  
WaterSound, FL 32461

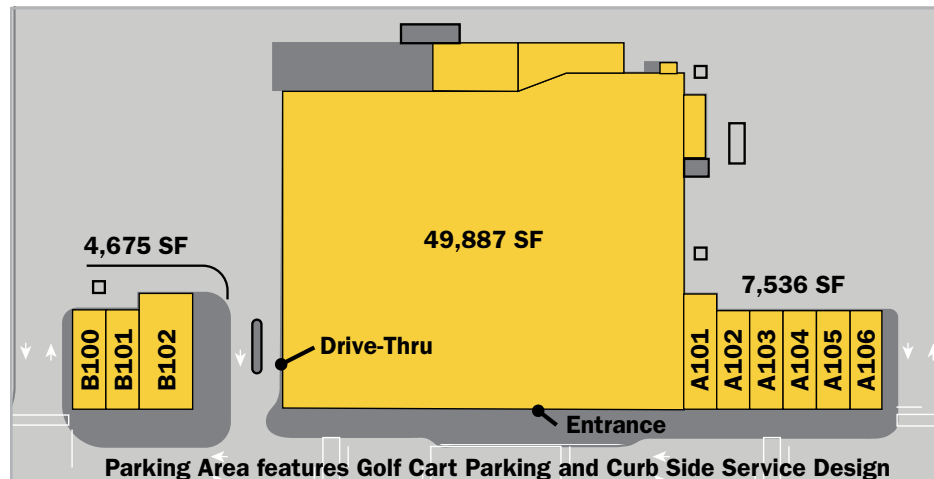



# WATERSOUND TOWN CENTER

*PUBLIX CENTER: RETAIL SPACE AVAILABLE*

## **EAST (ATTACHED) RETAIL FLOOR PLAN**

**5 UNITS / 5,999 SF**

- 1,200 SF each
- Units may be combined

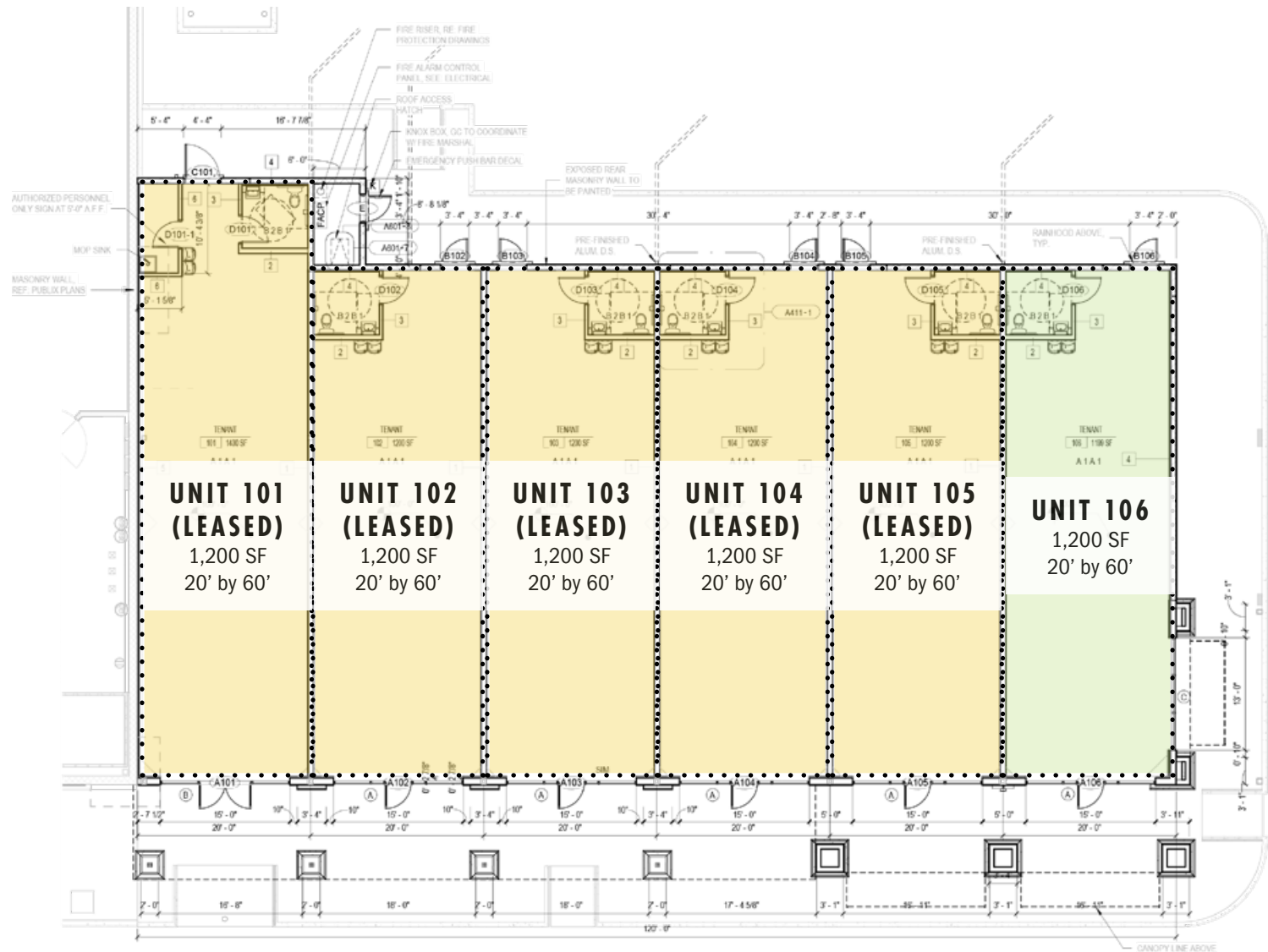



# WATERSOUND TOWN CENTER

*PUBLIX CENTER: RETAIL SPACE AVAILABLE*

## WEST (DETACHED) RETAIL FLOOR PLAN

**3 UNITS / 4,675 SF**

- 1,200
- 1,200
- 2,275
- Units may be combined

